



**What:** Flooring Abatement

**Where:** Corridor 390

**Start Date:** 11/30/2020

**Impact:** Limited user access during ceiling removal (see shaded areas)

**Contacts:**

- Vic Hoyecki – Project Superintendent – (203)943-2950
- Pam Buonocore – KGL Operations Manager – (203)915-4651
- Mark Veroneau – Yale Associate Project Manager – (475)241-2476

Acoustic and Audio Visual Consultant	CAYANAUGH TOCCI ASSOCIATES Inc.
Building Envelope Consultant	LEAVITT ASSOCIATES Inc.
Civil Engineer	LANGAN ENGINEERING
Code Consultant	PHILIP R. SHERMAN, P.E.
Landscape Architects	JAMES CORNER FIELD OPERATIONS
Lighting Designer	CBBLD Inc.
Mechanical, Electrical, & Plumbing Engineer	ARUP
Structural Engineer	GILZANZ MURRAY STEFECIK LLP
Specification Writer	KALIN ASSOCIATES Inc.

**CENTERBROOK**  
Architects and Planners, LLP  
67 Main Street  
Post Office Box 955  
Centerbrook, Connecticut 06409-0955  
Telephone 860.767.0175  
Facsimile 860.767.8719

GENERAL NOTES - FLOOR PLAN

- DIMENSIONS NOTED AS "EQUAL" OR "EQ" WITHIN A ROOM REFER TO A DISTANCE RELATIONSHIP CONTAINED ONLY IN THAT ROOM AT AN OPPOSING OR PARALLEL WALL UNLESS NOTED OTHERWISE.
- TYPICAL CODE-REQUIRED MANEUVERING CLEARANCES FOR ACCESSIBILITY AT DOORS IS SHOWN IN THE CODE PLANS LEGEND. THE REQUIRED MANEUVERING CLEARANCES FOR EACH DOOR ARE SHOWN ON THE FLOOR PLAN OR LAYOUT DRAWINGS. THE CONTRACTOR SHALL BE FULLY RESPONSIBLE TO COORDINATE THE REQUIREMENT FOR MANEUVERING CLEARANCES WITH SUBCONTRACTORS, VENDORS AND INSTALLERS AND VERIFY THAT THE INSTALLED WORK WILL PROVIDE THE REQUIRED MANEUVERING CLEARANCES. REPORT ALL DEVIATIONS FROM THE MANEUVERING CLEARANCE REQUIREMENTS TO THE ARCHITECT. DO NOT PROCEED WITH THE INSTALLATION OF ANY WORK ENCRANCHING ON THE REQUIRED MANEUVERING CLEARANCES UNTIL THE ISSUE HAS BEEN RESOLVED WITH THE ARCHITECT. MAKE NECESSARY CORRECTIONS.
- DIMENSIONS SHOWN ON ARCHITECTURAL FLOOR PLANS AND ENLARGED PLAN DETAILS ARE TO FACE OF STUD, TO FACE OF MASONRY OR TO CENTER LINE OF COLUMN UNLESS OTHERWISE NOTED.
- ENSURE FINISH SURFACES ARE FLUSH AND SEAMLESS WHERE PARTITIONS AND/OR FURRING ARE COPLANAR.
- ALL PIPING, CONDUITS AND RELATED MECHANICAL AND ELECTRICAL ITEMS SHALL BE CONCEALED WITHIN PARTITION WALL ASSEMBLY IN FINISHED AREA, U.N.O.
- PROVIDE BACKING/BLOCKING TO SUPPORT ALL WALL MOUNTED ITEMS.
- ALL MECHANICAL PADS TO BE 4" HIGH MINIMUM. U.N.O. SIZE OF PAD TO BE VERIFIED BY CONTRACTOR.
- PITCH SLABS (AND OTHER FLOORS) TO FLOOR DRAINS, TYP.

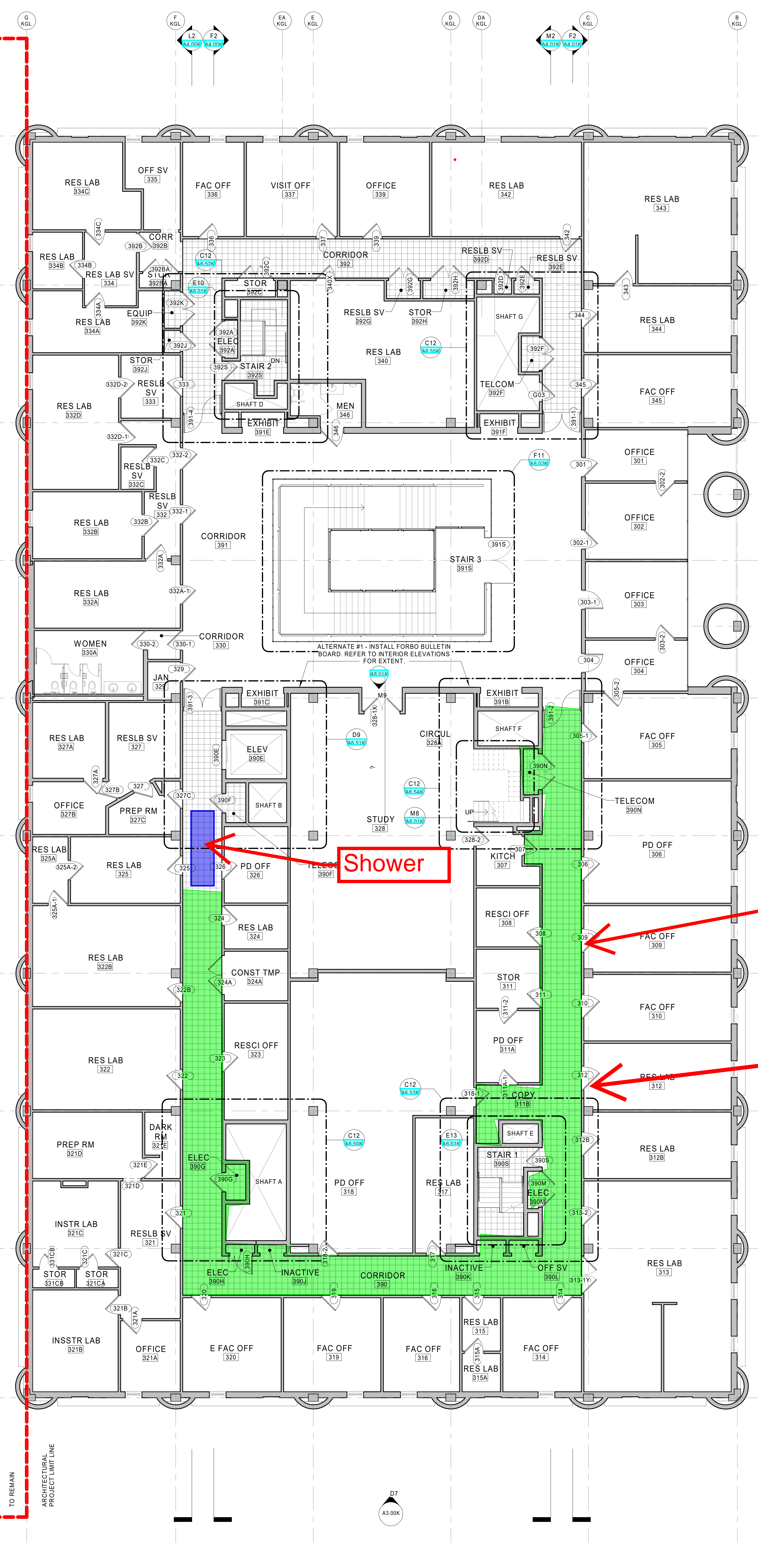

Shower

Containment

No Access Date: 11/30/20  
Reopening Date: 12/9/20

KGL 3rd Floor Corridor Flooring Abatement Work  
Yale Kline Geology Laboratory Code Upgrades Project  
New Haven, CT  
Turner Project No. 201026  
Data Date: November 19, 2020  
By: VJH

OVERALL PLAN LEGEND:

[Symbol]	EXISTING WALLS
[Symbol]	NEW WALLS
[Symbol]	EXISTING DOORS
[Symbol]	NEW DOORS
[Symbol]	AREA BEYOND ARCHITECTURAL PROJECT SCOPE
[Symbol]	OWNER FURNISHED
[Symbol]	ARCHITECTURAL WOODWORK AND CASEWORK
[Symbol]	RF-1 - NEW BBT FLOORING INCLUDING EGRESS STAIR TREADS UNLESS NOTED OTHERWISE IN FLOOR FINISH SCHEDULE
[Symbol]	PCF-2 - GROUND, SEALED AND POLISHED CONCRETE

